



FAYMONVILLE 
TRAILERS TO THE **MAX**

MEGAMAX



**Lowest double drop
- highest performance**

www.faymonville.us



BÜLLINGEN (BE)

since 1988 - 30.000 m²



With an experience of **over 50 years**, Faymonville is one of the biggest manufacturers of semi-trailers for special and heavy haulage.

Faymonville provides their customers with optimal solutions and systems for any transport need outside the usual norms.

Quality, flexibility, productivity, creativity and service are the company's keywords. The range of products and services is constantly enlarged in tight collaboration with our customers.

GOLENIOW (PL)

since 2006 - 21.000 m²



The high level of **innovation** and the **excellent manufacturing quality** of the products are secured by optimized production processes and own modern production plants in Büllingen (Belgium), Lentzweiler (Luxembourg) and Goleniow (Poland). A service station has been opened in Noginsk (near Moscow, Russia).

NOGINSK (RU)

since 2014 - 3.120 m²



LENTZWEILER II (LU)

since 2015 - 16.000 m²



LENTZWEILER I (LU)

since 2003 - 20.250 m²

Lowest double drop - highest performance

The Faymonville MegaMAX is a super low double drop trailer. It is available with diverse deck types, such as the lowest stretch perimeter deck available in the market or a non-stretch flat deck. It is the ideal solution for extremely high and bulky goods, such as industrial parts, machinery or oversized containers. Moreover, its king-pin steering is a unique feature in North America. With its unmatched maneuverability, it allows access into extremely tight areas.

The MegaMAX is available with 3 axles on air suspension. With a compressed length of 53' total and a width of 100" without outriggers, it can be run empty without any escorts or permits.

Main advantages

- ✓ Hydraulic self-lifting detachable gooseneck for continuous height adjustment and easy access with machines
- ✓ 108" gooseneck rear swing clearance
- ✓ Super low perimeter stretch deck – 13.8" drive height (at 3.9" ground clearance)
- ✓ Deck length 25' closed – stretches to 42'4"
- ✓ Detachable rear bogie to additionally increase the length using deck inserts (79"-118"-158")
- ✓ Also available with non-stretch flat deck - 10.8" drive height (at 3.9" ground clearance)
- ✓ Automatically steering axles (king-pin steering), with override remote-control
- ✓ 42° steering angle
- ✓ Air suspension (total stroke of 9.4")
- ✓ PTO connection and Honda pony motor for hydraulic functions
- ✓ Around 100,000 lbs technical capacity
- ✓ The chassis is fully metallized (zinc plated) – state-of-the-art protection against rust (see p.11)
- ✓ Extremely strong chassis
- ✓ Multiple lashing rings and load fixing points
- ✓ Numerous options and accessories available



Electric and pneumatic components are DOT approved, following US standards.



Automatic king-pin steering with additional remote control steering override.



Check out how the king-pin steering works!

Technical data

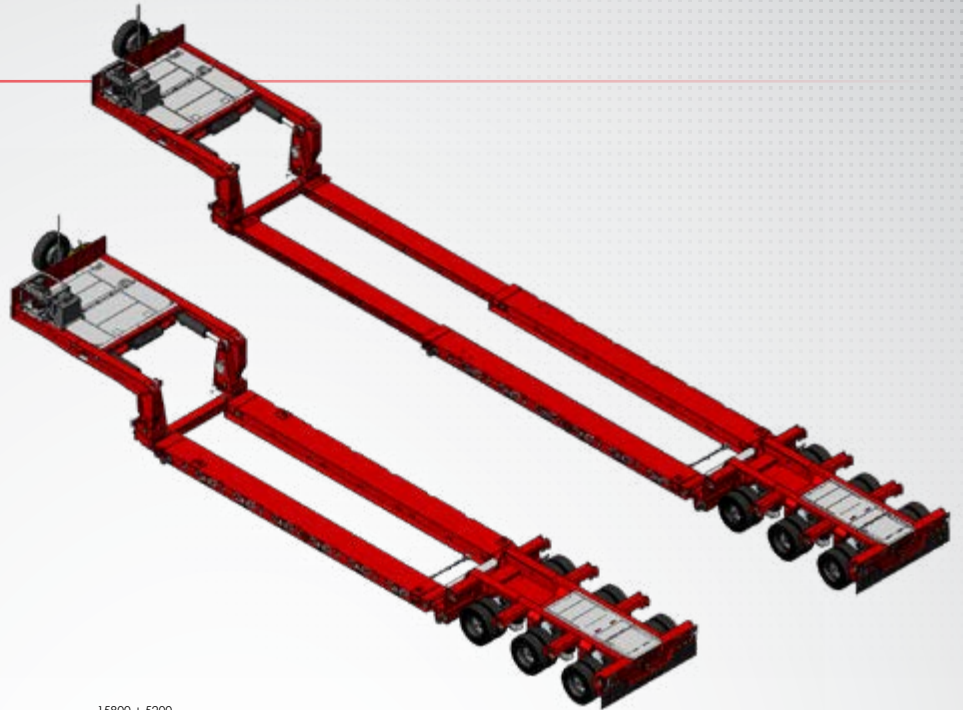

With perimeter deck

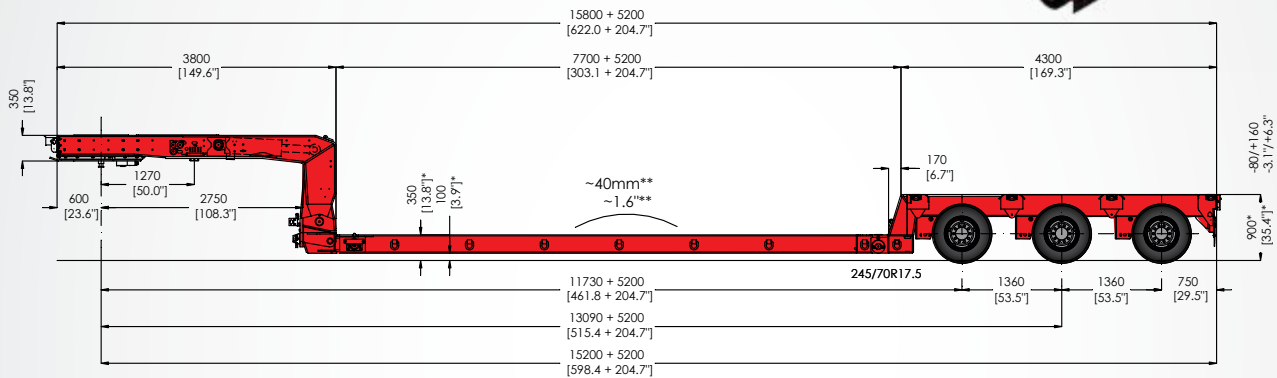

Speed	50mph	80km/h
Axle load 3 x	26 450 lbs	12 000 kg
5th wheel load	66 150 lbs	30 000 kg
Total weight	145 500 lbs	66 000 kg
Dead weight steerable* (+/-3%)	35 500 lbs	16 100 kg
Dead weight non-steerable* (+/-3%)	32 200 lbs	14 600 kg
Max. payload steerable**	110 000 lbs	49 900 kg
Max. payload non-steerable**	113 300 lbs	51 400 kg
Tires	245/70R 17.5	
Overall length	51' 10"	15 800 mm
Gooseneck swing	108.3"	2 750 mm
Deck length	25' 4" + 17' 7" (+inserts)	7 700 mm + 5 200 mm (+ inserts)
Loading height	13.8"	350 mm
Ground clearance	3.9"	100 mm
Bogie height (loaded)	35.4"	900 mm
Air suspension stroke	-3.1" /+ 6.3"	-80/+160 mm
Axle distance	53.5"	1 360 mm
Width (without outriggers)	100"	2 540 mm
Axle steering angle	42°	

* in basic version – without removable deck sections or deck inserts

** with trailer in basic version and following the load chart

Technical data

With flat deck

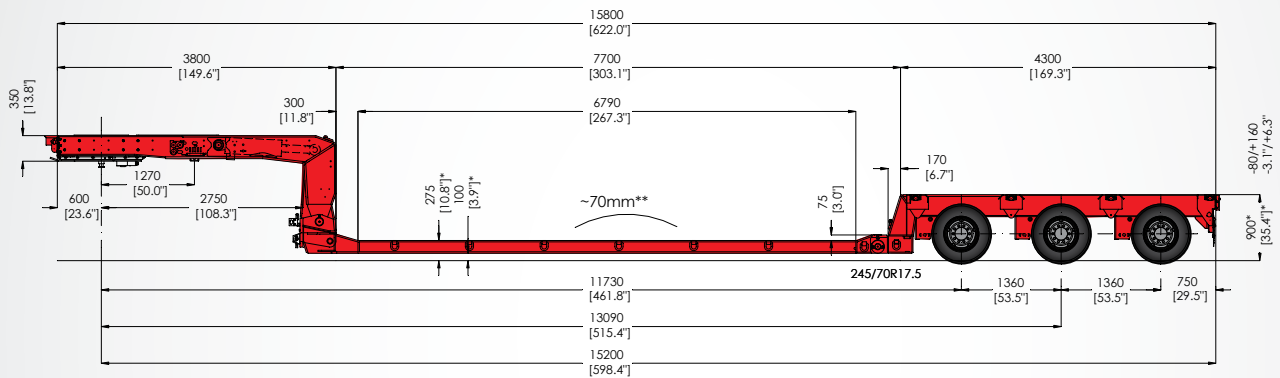

Speed	50mph	80km/h
Axle load 3 x	26 450 lbs	12 000 kg
5th wheel load	66 150 lbs	30 000 kg
Total weight	145 500 lbs	66 000 kg
Dead weight steerable (+/-3%)	34 000 lbs	15 400 kg
Dead weight non-steerable (+/-3%)	30 650 lbs	13 900 kg
Max. payload steerable**	111 570 lbs	50 600 kg
Max. payload non-steerable**	114 880 lbs	52 100 kg
Max. deck capacity over 100"	90 000 lbs	40 815 kg
Tires	245/70R 17.5	
Overall length	622"	15 800 mm
Gooseneck swing	108.3"	2 750 mm
Deck length*	22' 6" (no stretch or inserts)	6 790 mm (no stretch or inserts)
Loading height	10.8"	275 mm
Ground clearance	3.9"	100 mm
Bogie height (loaded)	35.4"	900 mm
Air suspension stroke	-3.1" /+ 6.3"	-80/+160 mm
Axle distance	53.5"	1 360 mm
Width (no outriggers available)	100"	2 540 mm
Axle steering angle	42°	

* in the lowest part of the deck
** following the load chart

Equipment of the MegaMAX

INCLUDED:

1. Head board with PTO connection and 1 spare wheel
2. Hydraulic detachable gooseneck
3. Galvanized ramps to access the deck with machinery
4. Steerable axles (also available with rigid axles)

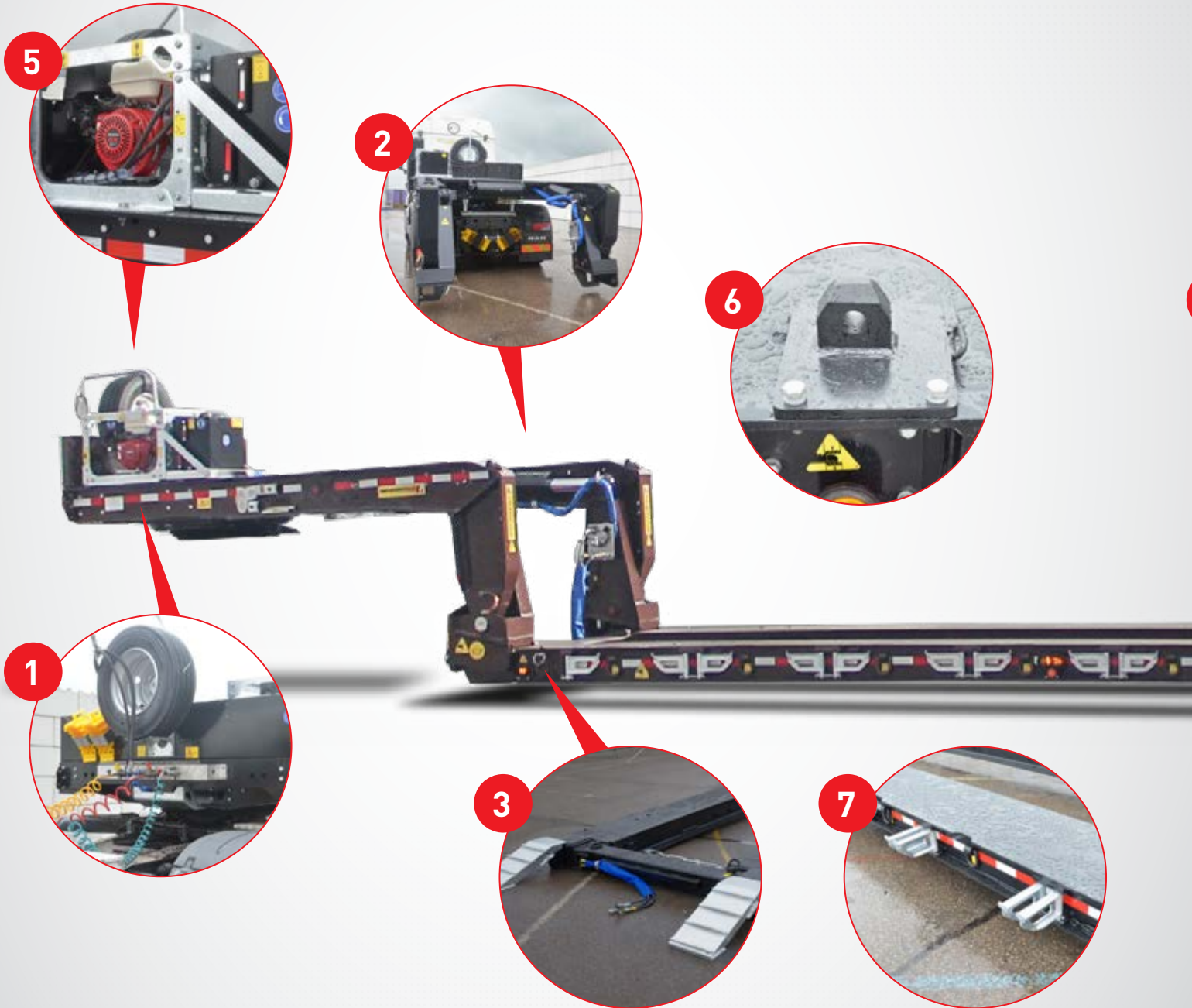

Check out the full MegaMAX product video!

OPTIONAL:

- 5. Honda pony motor (recommended)
- 6. Container fittings 1x20' / 1x40' *
- 7. Outriggers *
- 8. Removable deck sections *
- 9. Deck inserts *
- 10. Last axle liftable

* only for perimeter deck



- Hydraulic detachable gooseneck



- Perimeter deck stretch



- Perimeter deck inserts

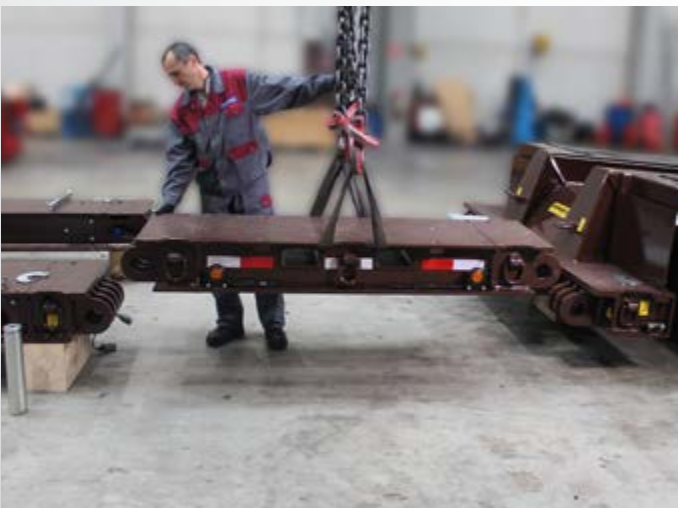

MAXPROTECT+

Weather conditions and environmental influences as well as corrosion and stone chips are the biggest enemies of a steel structure. For the long-term surface protection of semi-trailers, FAYMONVILLE relies on MAXProtect+, a fully co-ordinated and meticulously optimised surface treatment system.

MAXProtect+ is by far the best concept currently available in the industry. That is why it sets the benchmark in the field of surface protection. Our MAXProtect+ treatment offers a long-life surface protection.

All stages and processes included in MAXProtect+ – from the painting to the metallisation, including shot- and sandblasting – are carried out, developed and tested 'in-house'.

This optimum surface treatment additionally increases the quality and longevity of our products.

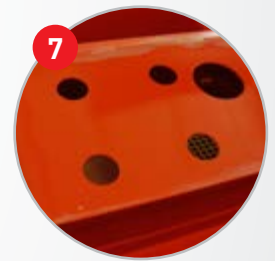
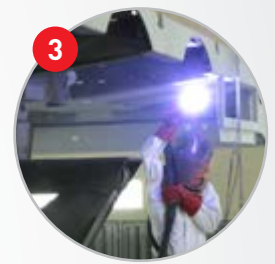

Composition of the surface refinement

- 1 Machine blasting:** Airless blast cleaning with metallic shot.
- 2 Manual blasting:** Manual cleaning and refinement of the material surface with mineral blasting agents.
- 3 Spray galvanising:** Application of a zinc/aluminium layer for corrosion and adhesion protection.
Partial metallisation especially for strongly stressed surfaces.
- 4 Joint sealing:** Prevents the spread of rust in the gap and underneath the paintwork.
- 5 Priming:** 2-component zinc epoxy with 81% zinc content and additional active corrosion protection.
- 6 Top coat:** Final coating with 2-component DTM.
- 7 Sealing:** Prevents corrosion in corners and hollow spaces.
- 8 Optional:** Seawater-resistant complete preservation



www.faymonville.us



FAYMONVILLE DISTRIBUTION AG

8, Duarrefstrooss
L-9990 WEISWAMPACH
T: +352 /26 90 04 155
sales@faymonville.com